

neXus
eco



drivesolarPRO

SOLAR-POWERED SPEAKERPHONE WITH TTS (TEXT-TO-SPEECH)

USERMANUAL

DriveSolar PRO

Solar-powered Text-To-Speech Speakerphone

Contents

About DriveSolar PRO	4
Appearance and Function	5
Recommended Installation	6
Charging Your Speakerphone	7
Turning Your Speakerphone On/Off	8
Pairing	8-9
Connection Link/Between Speakerphone and Mobile Phone	10
Using the Speakerphone	11-12
Text-To-Speech Feature	13-14
Restore to Default Factory Settings	15
Care and Maintenance	15
Safety Information	16
Product Specifications	17
Nexus Warranty Information	18-19

About Drivesolar PRO

Drivesolar PRO features a built-in solar panel which charges the unit whilst positioned in direct sunlight. This helps to prolong talk and standby time in sunny conditions, although we still recommend that you charge the speakerphone by conventional means. The Drivesolar PRO's other main feature is 'Text-To-Speech' which announces instructions for users in 5 different languages and also indicates the unit's status (i.e. "connected, power-on/off" etc.) It also announces the name of the incoming caller (or phone number if the contact is not loaded into the speakerphone's phonebook). Fully portable and featuring DSP (digital signal processing), Drivesolar PRO is an ideal wireless hands-free solution for in-car or office use, providing you with impeccable sound quality.

Appearance and Function

- (1) Speaker
- (2) Microphone
- (3) LED
- (4) Charging Socket (5-pin USB)
- (5) Mode Button (Privacy Mode and Mute)
- (6) MFB Button (Multi-Function Button)
- (7) Volume Increase (V+)
- (8) Volume Decrease (V-)
- (9) Solar Panel
- (10) Windshield Mount

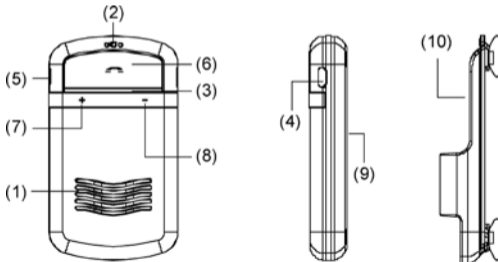

Recommended installation

We recommend that you position your speakerphone on the top right-hand side of your car's windscreen as shown in the picture below (opposite for left-hand drive vehicles):

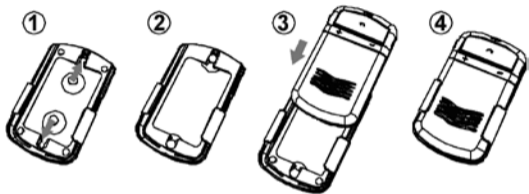

WARNING: Do not place or store the speakerphone over the area of the automobiles airbag deployment, or it may cause serious injury when a safety airbag deploys.

Charging Your Speakerphone

Your speakerphone comes with a built-in rechargeable battery. Prior to using the speakerphone, it is recommended to charge the battery fully for the first time.

Using the USB charging cable

- Connect the mini-USB (smaller) end of the USB cable to your speakerphone and plug the USB end into your computer/laptop's USB port (or any USB port). The speakerphone's LED turns red whilst charging. The speakerphone automatically powers off when charging.

Using the car charger (with USB cable)

- Connect the USB charging cable to the car charger and plug the car charger into your vehicle's car charger socket.
- Normal (full) charge time is 3 hours. (approx.) and the LED will flash off when charging is completed.

Using solar power

- Direct the solar panel on the back side of the speakerphone towards the sun. (Please refer to the recommended installation position, as mentioned above.)
- If the speakerphone receives sufficient sunlight for 2 hours, this will provide around 1 hour of talk time. Using solar power (with sufficient sunlight), the operation time (the talk time/standby time) will be extended continuously without any additional charge required by the car charger.

WARNING: Do not attempt to charge the speakerphone with any charger other than the one provided. Using another charger may damage the speakerphone and will void your warranty.

Turning your speakerphone On/Off.

Power On

Press and hold the "MFB" button for around four seconds and the flashing blue LED light indicator comes on ("Power On" is announced).

NOTE: Do not hold the button down for more than 8 seconds when turning on the speakerphone or else it may switch to its pairing mode. If this happens, turn off the speakerphone and repeat the process for turning on the speakerphone.

Power Off

Press and hold the "MFB" button until the LED light indication goes off ("Power Off" is announced).

Pairing

Pairing is the process of connecting your speakerphone with your mobile phone or Bluetooth device. Before using the speakerphone with your mobile phone, you must pair both devices together. This only needs to be done once for each phone. If you wish to use your speakerphone with a different mobile phone, you must reinitiate the pairing process with your new phone. The steps below describe pairing instructions for a typical Bluetooth enabled mobile phone.

- (1) Place the speakerphone and mobile phone no more than 1 metre (3 feet) apart.
- (2) Ensure the speakerphone is turned off.
- (3) Press and hold the "MFB" button for around 6 seconds until the LED flash red and blue alternately. Your speakerphone is now ready for pairing and "Pairing

phone, please put your phone in pairing mode and enter PIN code '0000' is announced.

- (4) Activate the Bluetooth function on your mobile phone and search for Bluetooth devices (Please refer to your mobile phone user guide for details).
- (5) Select "Drivesolar" from the list of searched devices.
- (6) Enter the pre-programmed code "0000" and press "OK" to pair the speakerphone and the mobile phone.
- (7) When pairing is completed, the speakerphone is under standby mode and the blue LED flashes every 3 seconds. Please place the mobile phone and the speakerphone within 10 meters (33 feet) sensing distance. ("Pairing Successful" is announced).

NOTE: If the pairing cannot be completed within 2 minutes after the pairing mode is activated, the speakerphone will power off automatically. Please repeat steps above to pair the speakerphone and mobile phone again.

Connection Link/Between Speakerphone and Mobile Phone

After pairing is completed, your speakerphone will be in standby mode and it should automatically connect to your phone (provided your phone's Bluetooth is turned on). "Connected to phone" is announced to confirm this. However, if this is not announced or the headset icon is not shown on your phone's screen, please follow the steps below to activate the Bluetooth connection/link through your mobile phone or speakerphone.

- On phone: Select the "Drivesolar PRO" from the paired list on your mobile phone's Bluetooth menu.
- On speakerphone: Short press the "MFB" and select "Accept" on phone's screen to accept connection.

NOTE: 1. Your speakerphone will automatically turn itself off when disconnected from a paired device for more than 10 minutes. This special feature is to maximize your speakerphone's standby/talk time. To reinstate the connection, simply repeat the process for turning speakerphone on.

2. If your speakerphone is set as an authorised Bluetooth device on your mobile phone, an automatic reconnection can be established by pressing the speakerphone's "MFB" button once.

Using the Speakerphone

(Most functions will be audibly announced)

(1) Answering a Call

When receiving a phone call, short press the "MFB" button to answer the call.

(2) Ending a Call

Short press the "MFB" button to end a call.

(3) Reject a Call

When you hear the ringing tone, press and hold the "MFB" button for 3 seconds to reject an incoming call.

(4) Voice Dial

If your mobile phone is voice dialing enabled, under standby mode, short press the "MFB" button once and say the name/voice tag after you hear a beep.

NOTE: Please make sure to record voice tag into the mobile phone before using voice dial function. Functionality varies depending on the mobile phone model. Please refer to your mobile phone's user guide for details on voice-dialing.

(5) Redial Last Outgoing Number

Press the "MFB" button twice for last number redials.

(6) Privacy Mode

In the middle of a conversation, press the "MODE" button once and the speaker volume automatically decreases to a minimal level so that you can use the speakerphone in the same manner as using any handheld phone.

(7) Mute & Un-mute the Microphone

- a. Mute: During a call, press and hold the "MODE" button for 3 seconds to mute the speakerphone's microphone.
- b. Un-Mute: Press and hold the "MODE" button for 3 seconds again.

(10) Transferring Calls

- a. Speakerphone to Mobile Phone: During a call, press both of "V+" and "V-" buttons, and the call is routed to your mobile phone.
- b. Mobile Phone to Speakerphone: Press the "MFB" button once to route the call to speakerphone.

(11) Adjusting the Volume

During a call, press the "V+" or "V-" buttons until you reach the desired volume level.

(12) Answer/Reject a second incoming call during an active call

- a. Answer: When receiving a second call, short press the "MFB" button once to hold the first call on line and answer the second call.
- b. Reject: When receiving a second call, press and hold the "MFB" button for 3 seconds to reject the second call.

(13) Switching between two phone calls

- a. When having two calls on the line, press and hold the "MFB" button for 3 seconds to switch between these two phone calls.
- b. When having two calls on the line, short press the "MFB" button once to end the first call and stay with the second call.

Text-To-Speech Feature**(1) Text-To-Speech Language Options**

Press the "V+" button for 3 seconds and the speakerphone announces "Select Language". Repeat this process to select the desired language in the following order: English, French, Italian, German and Spanish.

(2) Transferring your mobile phone's phonebook to speakerphone

a. Using speakerphone (For transferring the whole phonebook. Some mobile phone models may not support this method).
In the connected status, press the "MODE" button for around 3 seconds and the Blue LED light indicator will be constantly illuminated. When the process is completed, the speakerphone announces "Contacts Saved".

b. Using Mobile Phone (For transferring contacts one by one. All mobile phone models support this method).

1. In the connected status, press the "MODE" button for 6 seconds to enter the phonebook function. The speakerphone and mobile phone will disconnect automatically. The speakerphone will then be ready to receive the phonebook data from the mobile phone, and the Blue LED light indicator will flash once every second.

2. Select the contact person's data on the mobile phone's phonebook and transfer it to the speakerphone. (Please refer to your mobile phone's Bluetooth manual for details on how to transfer contacts or send business cards). When the process is completed, the speakerphone announces "Contacts Saved".

3. If the speakerphone has not received any contacts from the mobile phone within 2 minutes while in phonebook function, the speakerphone will resume the speakerphone function and automatically re-connect to the previously paired device.

4. To resume speakerphone function, short press the "MFB" button and the speakerphone will exit the phonebook function and re-connect with the previous paired device automatically.

NOTE:

1. The phonebook function varies from different mobile phone models and not every mobile phone supports this feature.

2. The phonebook data saved in the speakerphone will be erased automatically when it is paired with another mobile phone. Please repeat the procedures of phonebook transfer each time you connect your speakerphone with a new mobile phone.

(3) Removing Phonebook Entries

During standby mode, hold on to both "V+" and "V-" buttons for 3 seconds ("Phonebook Deleted" is announced) and the entire phonebook memory in the speakerphone will be deleted.

(4) Turning Text-To-Speech On/Off

To turn the TTS function 'On or Off', simply hold the "V-" for 3 seconds in standby mode ("Voice Prompt On" or "Voice Prompt Off" is announced to denote its current status).

Restore to Default Factory Settings

To restore your speakerphone to its original settings, press and hold both "V+" and "V-" buttons for 10 seconds until the blue LED light indication flashes rapidly. Press and hold both "V+" and "V-" buttons for a further 3 seconds and the speakerphone will power off automatically. This process is completed when speakerphone announces "Set Factory Default Completed".

Care and Maintenance

(1) Do not expose the speakerphone to liquid, moisture or humidity, as it is not waterproof.

(2) Do not use abrasive cleaning solvents to clean the speakerphone.

(3) Do not expose the speakerphone to extreme temperatures.

(4) Do not expose the speakerphone to contact with sharp objects as this will cause scratching and damage.

(5) Do not attempt to disassemble the speakerphone, as it does not contain serviceable components.

(6) If you do not use the speakerphone for long periods of time, be sure to store it in a dry place, free from extreme temperatures, humidity and dust.

Safety Information

- (1) Check local laws regarding use of a mobile phone and speakerphone while driving. If you use the speakerphone while driving, ensure your attention and focus remains on your responsibility of driving safely.
- (2) Never allow children to play with the speakerphone. Small parts may be a choking hazard.
- (3) Observe all signs that require an electrical device or RF radio product to be switched off in the designated areas. These could include hospitals, blasting areas, and potentially explosive atmospheres.
- (4) Turn off your speakerphone prior to boarding an aircraft. Do not use your speakerphone in an aircraft.
- (5) Never place or store the speakerphone over the area of the automobile's safety airbag deployment, or it may cause serious injury when a safety airbag deploys.

Product Specifications

Bluetooth Compliance: Bluetooth 2.0+EDR specifications

Operating Frequency Band: 2.4GHz ~ 2.48GHz unlicensed ISM band

Output Power: Class 2 Power Output, up to 10 meters

Support Profiles: Headset and Handsfree 1.5 profiles

TTS Support Language: English, French, Italian, German, Spanish

Integrated phonebook: Stores up to 450 contacts

Support Multiple Paired Devices: Paired device memory of 8 Bluetooth phones

Stand-by Time: Up to 450 hours

Talk time: Up to 13 hours

Battery Charging Time: Using charger about 3 hours;

Using solar power about 18 hours

Charger Voltage: DC5.0V 400mA

Battery Type: 3.7V 550mAH (Rechargeable Lithium-ion Battery)

Size: 92.5 x 54 x 15.5 mm

Weight: 60g (without windshield mount), 69g (with windshield mount)

NOTES: This speakerphone is in compliance with the specified Bluetooth version. It does not guarantee compatibility of all functions on every Bluetooth enabled device. Please check with your mobile phone's user manual for compatibility and functionality.

Nexus warranty information

Nexus offers a limited warranty for this product against any defects in material and workmanship for a period of one year from the date of purchase by the end user/consumer. The conditions of the warranty are as follows:

- The warranty is only valid upon presentation of the original receipt (from dealer/retailer) by the original purchaser with the product to be repaired or replaced.
- The warranty is void if the serial number, date of purchase and label has been removed.
- The warranty does not cover damage or product failure resulting from normal wear and tear, physical abuse, improper installation, misuse, modification or repairs by unauthorised third parties.
- Nexus does not assume responsibility for any loss or damage incurred during shipment or as a result of a force majeure.
- Nexus is not liable for any incidental or consequential damages arising from the use or misuse of this product.
- All warranty claims are limited to repair or replacement of the defective product and at the sole discretion of Nexus.

- If Nexus repairs or replaces the product, the product will be covered for the remaining time of the original warranty period. Repair or replacement may involve the use of reconditioned units which are equivalent in function. Replaced part or product becomes the property of Nexus.
- Consumable components such as batteries are not covered by the warranty.

For customer support please visit: www.nexus.co.uk

The Nexus brand is owned by Shebang Distribution Limited.



WEEE Directive 2002/96/EC Art.11(2)

The use of the symbol indicates that this product may not be treated as household waste. By ensuring this product is disposed of correctly you will help prevent potential negative consequences for the environment and for human health, which could otherwise be caused by inappropriate waste handling of this product. For more detailed information about recycling of this product, please contact your local council office or your household waste disposal service.

neXus
ACCESSORIES